

R15IB7T-IPA3WT 15" Panel PC (Intel® Celeron® Bay Trail-M N2930, 1.83 GHz)

Mechanical Design

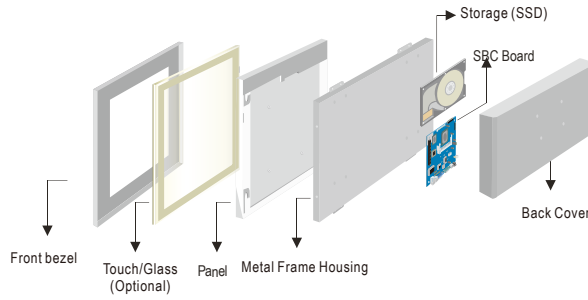

Panel Mount (10 mm front bezel)



Mechanical design

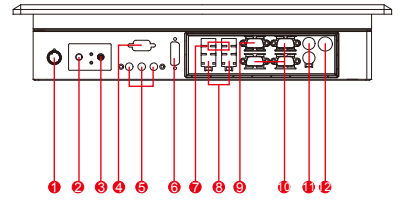

- | | |
|-------------------------------|----------------------|
| 1. Brightness Adjustment Knob | 7. USB |
| 2. Power On Button | 8. LAN |
| 3. Power Reset Button | 9. VGA Out |
| 4. RS-232 Conn.(Optional) | 10. RS-232 Conn. |
| 5. Audio Jack | 11. PS/2 |
| 6. DVI (Optional) | 12. DC-IN Power Jack |

Fully Integrated I/O

IP65 CUT OUT

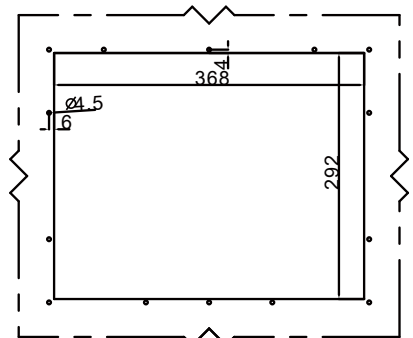

1:2

Measurements shown in mm
All Dimensions are ± 0.5 mm

* Note: this is a simplified drawing and some components are not marked in detail. Please contact our sales representative if you need further product information.

FRONT VIEW

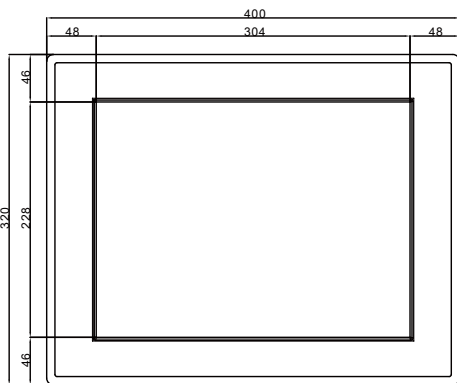

SIDE VIEW

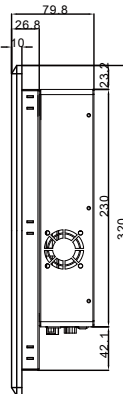

Dimensions

BACK VIEW

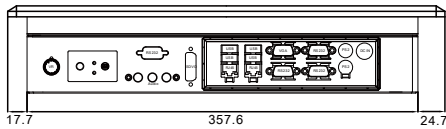
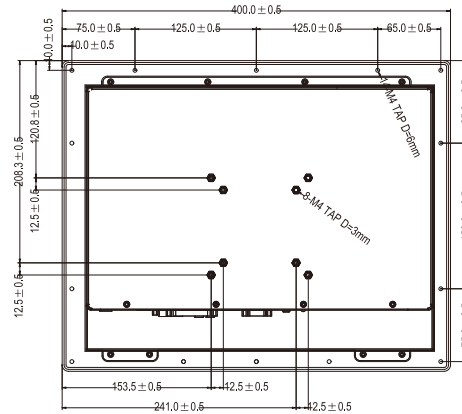

BOTTOM VIEW

Specifications

System:

- CPU : Intel® Celeron® Bay Trail-M N2930, 1.83 GHz
- Memory Slot : SODIMM DDR3L 1600/1333, max. 8GB
- System Chipset : Intel Atom SoC Integrated
- IDE/SATA : 1 x SATA II
- LAN : Intel I210-AT GbE LAN x 2
- Audio Codec : Realtek ALC886 HD Audio Codec
- Storage : mSATA SSD 64GB (Default)

Input / Output :

- Serial Ports : 2 x RS232, 1 x RS232/422/485^o
- USB Ports : 1 x USB 3.0, 3 x USB 2.0
- Keyboard/Mouse : 2 x PS/2
- Ethernet : 2 x RJ45-10/100/1000 Mbps
- VGA : 1 x VGA (female)
- Audio : Line-out, Line-in, Mic in
- Power : 1 x DC-in Power Jack(+12V) ^o Default: RS232

Expansion Slot :

- Mini PCIe : 2 x Mini PCIe (1 for WiFi, 1 for 3G Module)
- eDP : 1 x eDP by 2x10 DF-13 connector

Power Specifications :

- Power input : 12V DC
- Power Consumption : 38W (typ.)(Max.backlight & high CPU load)

Accessories :

- External Adapter : 110~240V AC

Panel Spec :

- Size/Type : 15" TFT
- Resolutions : 1024x768
- Brightness : 400cd/m (typ.)
- Contrast Ratio : 700 : 1 (typ.)
- Viewing Angle : -80~80(H); -80~60(V)
- Max. Colors : 16.2M / 262K colors

Environment Considerations :

- Operating Temperature : -20°C to 60°C
- Operating Humidity : 30% to 90% (non-condensing)

Order Options :

Touch : 5 Wires Resistive (Optional)

RAM : SODIMM DDR3L
1600/1333, max. 8GB
OS : Windows 10 IoT Enterprise
Windows 7 Embedded
Windows 8 Embedded